

84H
90H

2

SHELF	2
SHELF/DRAWER	3
DISPLAY	4
DISPLAY/DRAWER	6
EXPANDED METAL	7
CUBICLE	8
CUBICLE/SHELF	9
CORNER	10
TRAY STORAGE	10
BIN STORAGE	13
FILE DRAWER	14
SMOCK STORAGE	15
WARDROBE/STORAGE	16
CHEMICAL STORAGE	18
APPARATUS ROD STORAGE	19
TORSO/SKELETON STORAGE	19
MICROSCOPE STORAGE	20

STACK-ON

21

DESIGN DETAILS	21
SHELF	22
DISPLAY	23

INSTALLATION ACCESSORIES

24

SOFFIT TRIM	24
FILLERS	24
CLOSURES	24
SOFFIT FASCIA	25
SOFFIT EXTENSION	25
SOFFIT BRACKET	25
OVERLAY BACKS	26
FILE BARS	26

Rev. 06-13-24

©2023 STEVENS INDUSTRIES, INC.
ALL RIGHTS RESERVED.
Due to continuing product
development, Stevens reserves
the right to change specifications
without notice.

SHELF



47101

W : 12-48
H : 84, 90
D : 14, 17, 19, 23

- Fixed Shelf
- Adjustable Shelves: 4

SHELF

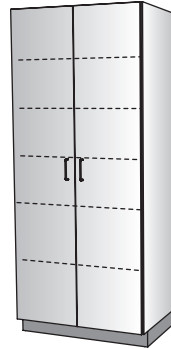

47129

W : 24-48
H : 84, 90
D : 14, 17, 19, 23

- Doors
- Fixed Shelf
- Adjustable Shelves: 4

SHELF



47120

W : 12-24
H : 84, 90
D : 14, 17, 19, 23

- Right Hinge Door
- Fixed Shelf
- Adjustable Shelves: 4

SHELF

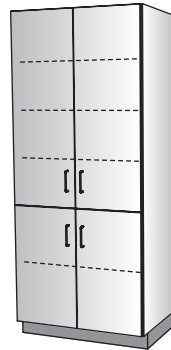

47126

W : 24-48
H : 84, 90
D : 14, 17, 19, 23

- Upper/Lower Doors
- Adjustable Shelves: 4

SHELF

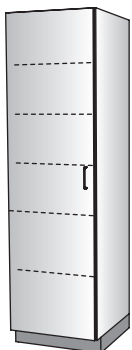

47121

W : 12-24
H : 84, 90
D : 14, 17, 19, 23

- Left Hinge Door
- Fixed Shelf
- Adjustable Shelves: 4

SHELF



47138

W : 30-48
H : 84, 90
D : 14, 17, 19, 23

- Center Divider
- Adjustable Shelves: 10

SHELF

47181

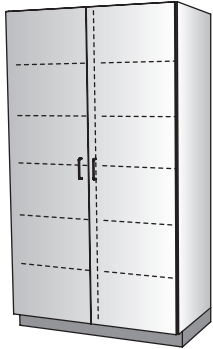

W : 30-48
H : 84, 90
D : 14, 17, 19, 23

- Doors
- Center Divider
- Adjustable Shelves: 10

SHELF/
DRAWER

47335



W : 39-48
H : 84, 90
D : 17, 19, 23

- Doors
- Center Divider
- Adjustable Shelves: 6
- Drawers: 3

SHELF

47150



W : 36, 39, 42, 45, 48
H : 84, 90
D : 17, 19, 23

- Upper/Lower Sliding Doors
- Center Dividers
- Adjustable Shelves: 8

SHELF/
DRAWER

47374



W : 39-48
H : 84, 90
D : 17, 19, 23

- Doors
- Center Divider
- Adjustable Shelves: 6
- Drawers: 4

DISPLAY



47130

W : 15-24
H : 84, 90
D : 17, 19, 23

- Right Hinge Display Door
- Fixed Shelf
- Adjustable Shelves: 4

DISPLAY

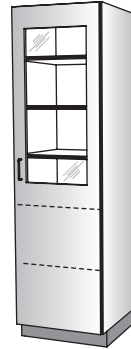

47132

W : 15-24
H : 84, 90
D : 17, 19, 23

- Right Hinge Display Door
- Fixed Shelf
- Adjustable Shelves: 4

DISPLAY



47131

W : 15-24
H : 84, 90
D : 17, 19, 23

- Left Hinge Display Door
- Fixed Shelf
- Adjustable Shelves: 4

DISPLAY

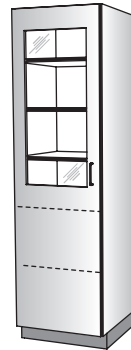

47133

W : 15-24
H : 84, 90
D : 17, 19, 23

- Left Hinge Display Door
- Fixed Shelf
- Adjustable Shelves: 4

DISPLAY



47137

W : 30, 36, 42, 48
H : 84, 90
D : 17, 19, 23

- Display Doors
- Center Divider
- Adjustable Shelves: 10

DISPLAY



47140

W : 30, 36, 42, 48
H : 84, 90
D : 17, 19, 23

- Display Doors
- Center Divider
- Adjustable Shelves: 10

DISPLAY



47182

W : 15-24
H : 84, 90
D : 17, 19, 23

- Right Hinge Upper/Lower Display Doors
- Adjustable Shelves: 4

DISPLAY



47135

W : 36, 42, 48
H : 84, 90
D : 17, 19, 23

- Upper Display Doors
- Lower Doors
- Adjustable Shelves: 4

DISPLAY



47183

W : 15-24
H : 84, 90
D : 17, 19, 23

- Left Hinge Upper/Lower Display Doors
- Adjustable Shelves: 4

DISPLAY



47154

W : 36, 42, 48
H : 84, 90
D : 17, 19, 23

- Upper Sliding Display Doors
- Lower Sliding Doors
- Center Dividers
- Adjustable Shelves: 8

DISPLAY



47184

W : 30, 36
H : 84, 90
D : 17, 19, 23

- Upper/Lower Display Doors
- Adjustable Shelves: 4

DISPLAY



47158

W : 36, 39, 42, 45, 48
H : 84, 90
D : 17, 19, 23

- Upper Sliding Glass Doors
- Lower Doors
- Center Dividers
- Adjustable Shelves: 8

**DISPLAY/
DRAWER**



47339

W: 42, 48
H: 84, 90
D: 17, 19, 23

- Display Doors
- Center Divider
- Adjustable Shelves: 6
- Drawers: 3

**DISPLAY/
DRAWER**



47379

W: 42, 48
H: 84, 90
D: 17, 19, 23

- Display Doors
- Center Divider
- Adjustable Shelves: 6
- Drawers: 4

**DISPLAY/
DRAWER**



47342

W: 42, 48
H: 84, 90
D: 17, 19, 23

- Sliding Display Doors
- Center Divider
- Adjustable Shelves: 6
- Drawers: 3

**DISPLAY/
DRAWER**



47378

W: 42, 48
H: 84, 90
D: 17, 19, 23

- Sliding Display Doors
- Center Divider
- Adjustable Shelves: 6
- Drawers: 4

**DISPLAY/
DRAWER**



47343

W: 39-48
H: 84, 90
D: 17, 19, 23

- Sliding Glass Doors
- Center Divider
- Adjustable Shelves: 6
- Drawers: 3

**DISPLAY/
DRAWER**



47383

W: 39-48
H: 84, 90
D: 17, 19, 23

- Sliding Glass Doors
- Center Divider
- Adjustable Shelves: 6
- Drawers: 4

**EXPANDED
METAL**



47106

W : 15-24
H : 84, 90
D : 17, 19, 23

- Right Hinge Framed Expanded Metal Door
- Adjustable Shelves: 4
- Expanded Metal Available in Black, White, Grey (color linked to accent color option)

**EXPANDED
METAL**

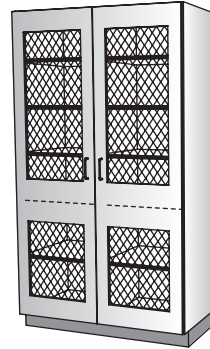

47109

W : 30, 36, 42, 48
H : 84, 90
D : 17, 19, 23

- Framed Expanded Metal Doors
- Center Divider
- Adjustable Shelves: 8
- Expanded Metal Available in Black, White, Grey (color linked to accent color option)

**EXPANDED
METAL**



47107

W : 15-24
H : 84, 90
D : 17, 19, 23

- Left Hinge Framed Expanded Metal Door
- Adjustable Shelves: 4
- Expanded Metal Available in Black, White, Grey (color linked to accent color option)

**EXPANDED
METAL**

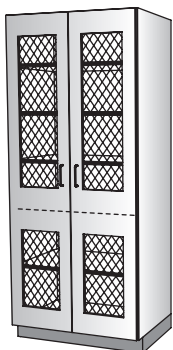

47108

W : 30, 36
H : 84, 90
D : 17, 19, 23

- Framed Expanded Metal Doors
- Adjustable Shelves: 4
- Expanded Metal Available in Black, White, Grey (color linked to accent color option)

CUBICLE



47213

W : 18, 24
H : 84, 90
D : 17, 19, 23

- 3/4" Adjustable Cubicle Shelves
- Compartments: 84H=14, 90H=16
- Compartment Spacing: 3"H min.
- Compartment Widths: 7 7/8" (18W), 10 7/8" (24W)

CUBICLE



47216

W : 30, 36, 42, 48
H : 84, 90
D : 17, 19, 23

- 3/4" Adjustable Cubicle Shelves
- Compartments: 84H=21, 90H=24
- Compartment Spacing: 3"H min.
- Compartment Widths: 9" (30W), 11" (36W), 13" (42W), 15" (48W)

CUBICLE



47214

W : 18, 24
H : 84, 90
D : 17, 19, 23

- Right Hinge Door
- 3/4" Adjustable Cubicle Shelves
- Compartments: 84H=14, 90H=16
- Compartment Spacing: 3"H min.
- Compartment Widths: 7 7/8" (18W), 10 7/8" (24W)

CUBICLE

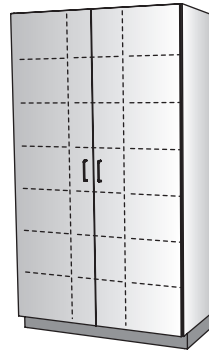

47217

W : 30, 36, 42, 48
H : 8, 90
D : 17, 19, 23

- Doors
- 3/4" Adjustable Cubicle Shelves
- Compartments: 84H=21, 90H=24
- Compartment Spacing: 3"H min.
- Compartment Widths: 9" (30W), 11" (36W), 13" (42W), 15" (48W)

CUBICLE



47215

W : 18, 24
H : 84, 90
D : 17, 19, 23

- Left Hinge Door
- 3/4" Adjustable Cubicle Shelves
- Compartments: 84H=14, 90H=16
- Compartment Spacing: 3"H min.
- Compartment Widths: 7 7/8" (18W), 10 7/8" (24W)

CUBICLE



47218

W : 36, 42, 48
H : 84, 90
D : 17, 19, 23

- 3/4" Adjustable Cubicle Shelves
- Compartments: 84H=28, 90H=32
- Compartment Spacing: 3"H min.
- Compartment Widths: 8" (36W), 9 1/2" (42W), 11" (48W)

CUBICLE

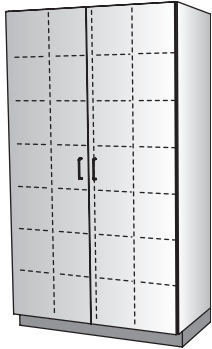

47219

W : 36, 42, 48
H : 84, 90
D : 17, 19, 23

- Doors
- 3/4" Adjustable Cubicle Shelves
- Compartments: 84H=28, 90H=32
- Compartment Spacing: 3"H min.
- Compartment Widths: 8" (36W), 9 1/2" (42W), 11" (48W)

CUBICLE/
SHELF

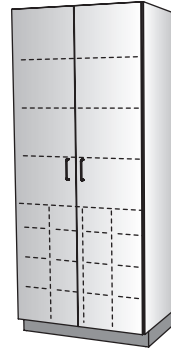

47251

W : 36, 42, 48
H : 84, 90
D : 17, 19, 23

- Doors
- Adjustable Shelves: 3
- 3/4" Adjustable Cubicle Shelves
- Compartments: 16
- Compartment Spacing: 3"H min.
- Compartment Width: 8" (36W), 9 1/2" (42W), 11" (48W)

CUBICLE/
SHELF

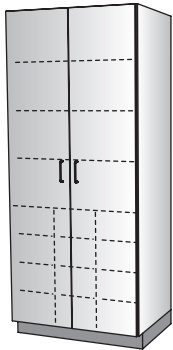

47236

W : 30, 36, 42, 48
H : 84, 90
D : 17, 19, 23

- Doors
- Adjustable Shelves: 3
- 3/4" Adjustable Cubicle Shelves
- Compartments: 12
- Compartment Spacing: 3"H min.
- Compartment Widths: 9" (30W), 11" (36W), 13" (42W), 15" (48W)

CUBICLE/
SHELF

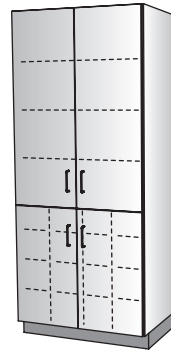

47246

W : 36, 42, 48
H : 84, 90
D : 17, 19, 23

- Upper/Lower Doors
- Adjustable Shelves: 3
- 3/4" Adjustable Cubicle Shelves
- Compartments: 16
- Compartment Spacing: 3"H min.
- Compartment Width: 8" (36W), 9 1/2" (42W), 11" (48W)

CUBICLE/
SHELF



47231

W : 30, 36, 42, 48
H : 84, 90
D : 17, 19, 23

- Upper/Lower Doors
- Adjustable Shelves: 3
- 3/4" Adjustable Cubicle Shelves
- Compartments: 12
- Compartment Spacing: 3"H min.
- Compartment Widths: 9" (30W), 11" (36W), 13" (42W), 15" (48W)



SA902: 10W x 3 1/2H x 19D

TALL

**BLIND
CORNER**

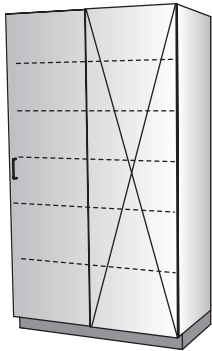

47200

W : 33, 36, 39
H : 84, 90
D : 17

W : 36, 39, 42
H : 84, 90
D : 19

W : 39, 42, 45, 48
H : 84, 90
D : 23

- Right Hinge Door
- Fixed Shelf
- Adjustable Shelves: 4

**TRAY
STORAGE**



47263

W : 24
H : 84
D : 23

- SA902 Molded Trays: 32

**BLIND
CORNER**

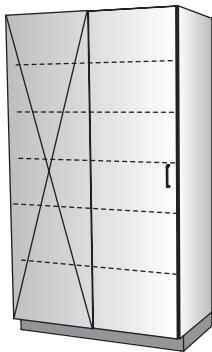

47201

W : 33, 36, 39
H : 84, 90
D : 17

W : 36, 39, 42
H : 84, 90
D : 19

W : 39, 42, 45, 48
H : 84, 90
D : 23

- Left Hinge Door
- Fixed Shelf
- Adjustable Shelves: 4

**TRAY
STORAGE**

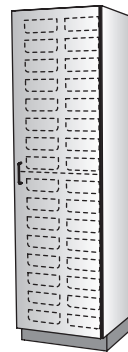

47264

W : 24
H : 84
D : 23

- Right Hinge Door
- SA902 Molded Trays: 32

**TRAY
STORAGE**

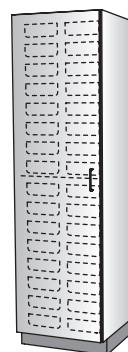

47265

W : 24
H : 84
D : 23

- Left Hinge Door
- SA902 Molded Trays: 32



SA901: 14 1/4W x 3 1/2H x 19D



SA902: 10W x 3 1/2H x 19D

TALL

**TRAY
STORAGE**

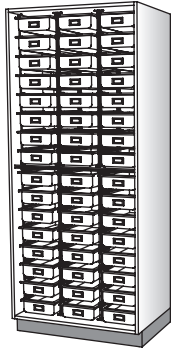

47270

W : 36
H : 84
D : 23

- SA902 Molded Trays: 48

**TRAY
STORAGE**



47274

W : 48
H : 84
D : 23

- SA901 Molded Trays: 48

**TRAY
STORAGE**

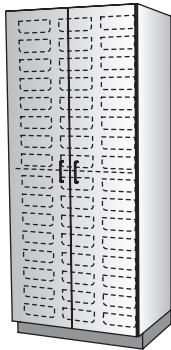

47271

W : 36
H : 84
D : 23

- Doors
- SA902 Molded Trays: 48

**TRAY
STORAGE**

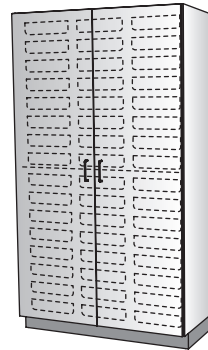

47275

W : 48
H : 84
D : 23

- Doors
- SA901 Molded Trays: 48

**TRAY
STORAGE**

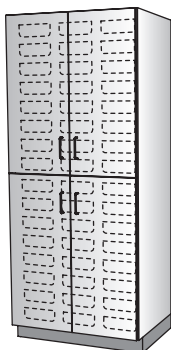

47287

W : 36
H : 84
D : 23

- Upper/Lower Doors
- SA902 Molded Trays: 48

**TRAY
STORAGE**

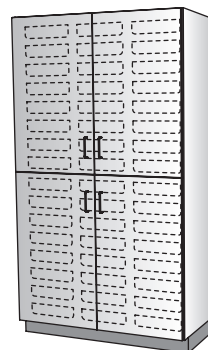

47288

W : 48
H : 84
D : 23

- Upper/Lower Doors
- SA901 Molded Trays: 48



SA902: 10W x 3 1/2H x 19D

TALL

**TRAY
STORAGE**

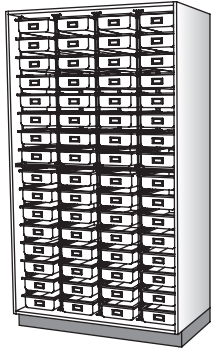

47281

W : 48
H : 84
D : 23

- SA902 Molded Trays: 64

**TRAY STORAGE/
SHELF**



47302

W : 36
H : 84, 90
D : 23

- Upper/Lower Doors
- Adjustable Shelves: 3
- SA902 Molded Trays: 18

**TRAY
STORAGE**

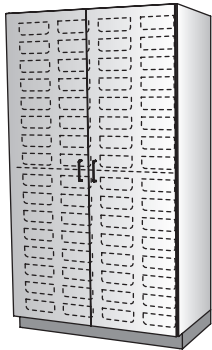

47282

W : 48
H : 84
D : 23

- Doors
- SA902 Molded Trays: 64

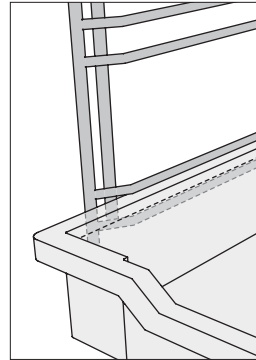

Tray and bin racks have captured runner rail to reduce tray tipout.

**TRAY
STORAGE**

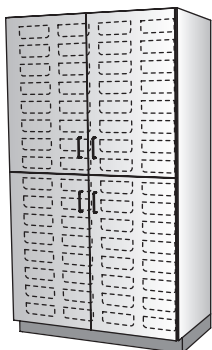

47289

W : 48
H : 84
D : 23

- Upper/Lower Doors
- SA902 Molded Trays: 64



SA910: 12¼W x 3H x 16¾D



SA911: 12¼W x 6H x 16¾D

TALL

**BIN
STORAGE**

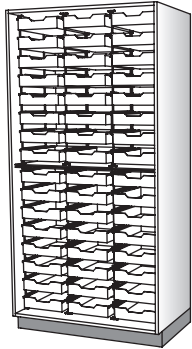

47242

W : 42
H : 84
D : 23

- SA910 Molded Translucent Bins: 48

**BIN
STORAGE**

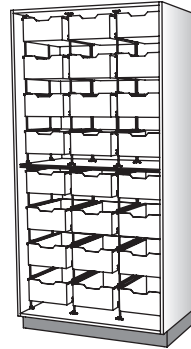

47244

W : 42
H : 84
D : 23

- SA911 Molded Translucent Bins: 24

**BIN
STORAGE**

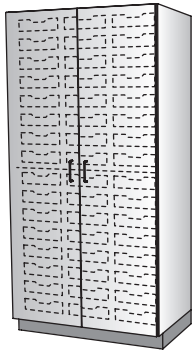

47243

W : 42
H : 84
D : 23

- Doors
- SA910 Molded Translucent Bins: 48

**BIN
STORAGE**

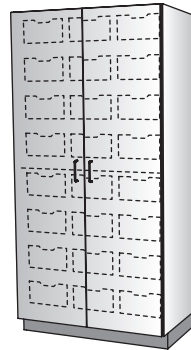

47245

W : 42
H : 84
D : 23

- Doors
- SA911 Molded Translucent Bins: 24

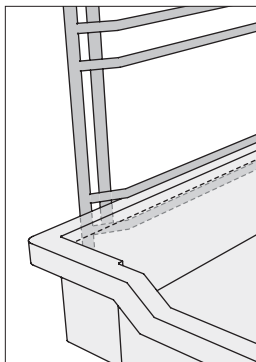

Tray and bin racks have captured runner rail to reduce tray tipout.

**FILE
DRAWER**



47326

W : 16, 19
H : 84, 90
D : 23

- Adjustable Shelves: 2
- Full Extension File Drawers: 3
- Includes Crossbars for Side Filing
- Letter File Drawers (16W)
- Legal File Drawers (19W)

**FILE
DRAWER**

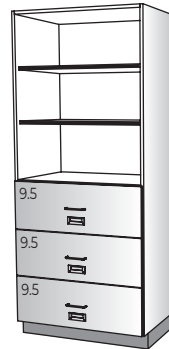

47322

W : 30, 36
H : 84, 90
D : 23

- Adjustable Shelves: 2
- Full Extension Lateral File Drawers: 3
- Includes Divider for Side Filing and File Bars for Front-to-Back Filing
- Drawer Box Depth: 440mm

**FILE
DRAWER**



47327

W : 16, 19
H : 84, 90
D : 23

- Right Hinge Door
- Adjustable Shelves: 2
- Full Extension File Drawers: 3
- Includes Crossbars for Side Filing
- Letter File Drawers (16W)
- Legal File Drawers (19W)

**FILE
DRAWER**

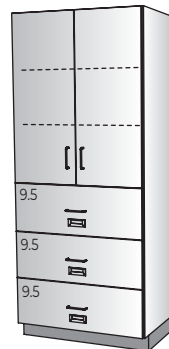

47323

W : 30, 36
H : 84, 90
D : 23

- Doors
- Adjustable Shelves: 2
- Full Extension Lateral File Drawers: 3
- Includes Divider for Side Filing and File Bars for Front-to-Back Filing
- Drawer Box Depth: 440mm

**FILE
DRAWER**



47328

W : 16, 19
H : 84, 90
D : 23

- Left Hinge Door
- Adjustable Shelves: 2
- Full Extension File Drawers: 3
- Includes Crossbars for Side Filing
- Letter File Drawers (16W)
- Legal File Drawers (19W)

SMOCK
STORAGE



47611

W : 18, 24
H : 84, 90
D : 23

- Right Hinge Door
- Fixed Shelf
- SA364MN Double J Shelf Hooks: 14

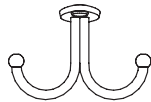

SMOCK
STORAGE



47612

W : 18, 24
H : 84, 90
D : 23

- Left Hinge Door
- Fixed Shelf
- SA364MN Double J Shelf Hooks: 14

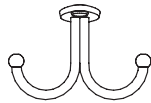

SMOCK
STORAGE

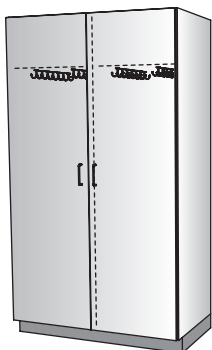

47556

W : 36, 48
H : 84, 90
D : 23

- Doors
- Center Divider
- Fixed Shelves
- SA364MN Double J Shelf Hooks: 28

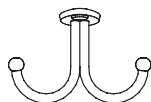

WARDROBE/
STORAGE



47543

W : 15-24
H : 84, 90
D : 23

- Right Hinge Door
- Hanger Bar
- Adjustable Shelf (Factory Located)

WARDROBE/
STORAGE



47618

W : 36
H : 84, 90
D : 23

- Locked Doors
- Full Height Divider
- Left: 5 Adjustable Shelves
- Right: Adjustable Shelf, Wardrobe Hook, Mirror

WARDROBE/
STORAGE



47544

W : 15-24
H : 84, 90
D : 23

- Left Hinge Door
- Hanger Bar
- Adjustable Shelf (Factory Located)

WARDROBE/
STORAGE

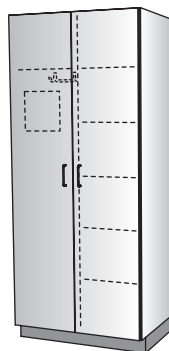

47617

W : 36
H : 84, 90
D : 23

- Locked Doors
- Full Height Divider
- Left: Adjustable Shelf, Wardrobe Hook, Mirror
- Right: 5 Adjustable Shelves

**WARDROBE/
STORAGE**

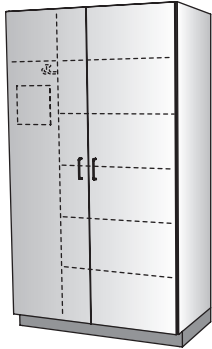

47603

W : 30-48
H : 84, 90
D : 23

- Locked Doors
- Full Height Divider
- Left: Adjustable Shelf, Wardrobe Hook, Mirror
- Right: 5 Adjustable Shelves

**WARDROBE/
STORAGE**

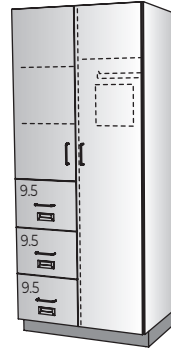

47653

W : 32, 38
H : 84, 90
D : 23

- Locked Doors
- Full Height Center Divider
- Left: 3 Full Extension Locked File Drawers, Storage Compartment with 2 Adjustable Shelves
- Right: Adjustable Shelf, Hanger Bar, Mirror
- Includes Crossbar for Side Filing
- Letter File Drawers (32W)
- Legal File Drawers (38W)

**WARDROBE/
STORAGE**

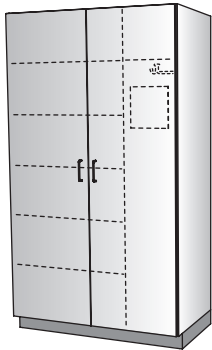

47605

W : 30-48
H : 84, 90
D : 23

- Locked Doors
- Full Height Divider
- Left: 5 Adjustable Shelves
- Right: Adjustable Shelf, Wardrobe Hook, Mirror

**WARDROBE/
STORAGE**

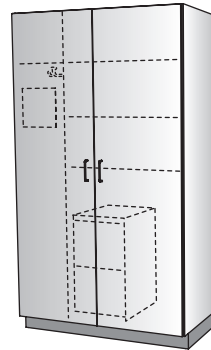

47606

W : 36-48
H : 84, 90
D : 23

- Locked Doors
- Full Height Divider
- Left: Adjustable Shelf, Wardrobe Hook, Mirror
- Right: 3 Adjustable Shelves, 2 Full Extension Letter File Drawers

**WARDROBE/
STORAGE**

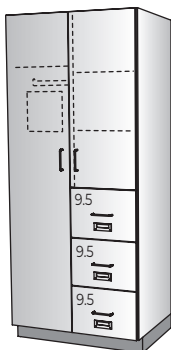

47657

W : 32, 38
H : 84, 90
D : 23

- Locked Doors
- Full Height Center Divider
- Left: Adjustable Shelf, Hanger Bar, Mirror
- Right: 3 Full Extension Locked File Drawers, Storage Compartment with 2 Adjustable Shelves
- Includes Crossbar for Side Filing
- Letter File Drawers (32W)
- Legal File Drawers (38W)

**WARDROBE/
STORAGE**

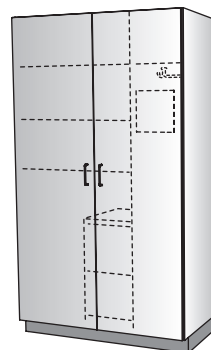

47607

W : 36-48
H : 84, 90
D : 23

- Locked Doors
- Full Height Divider
- Left: 3 Adjustable Shelves, 2 Full Extension Letter File Drawers
- Right: Adjustable Shelf, Wardrobe Hook, Mirror

**CHEMICAL
STORAGE**



47734

W : 15, 18
H : 84
D : 19, 23

- Right Hinge Door
- Black A-tech Shelves with Front Retaining Ledge: 5

**CHEMICAL
STORAGE**



47740

W : 24
H : 84
D : 23

- Right Hinge Door
- Trays on Adjustable Shelves: 5

**CHEMICAL
STORAGE**



47735

W : 15, 18
H : 84
D : 19, 23

- Left Hinge Door
- Black A-tech Shelves with Front Retaining Ledge: 5

**CHEMICAL
STORAGE**



47741

W : 24
H : 84
D : 23

- Left Hinge Door
- Trays on Adjustable Shelves: 5

**CHEMICAL
STORAGE**



47737

W : 30, 36
H : 84
D : 19, 23

- Doors
- Center Divider
- Black A-tech Shelves with Front Retaining Ledge: 10

**CHEMICAL
STORAGE**



47742

W : 30, 36
H : 84
D : 23

- Double Doors
- Trays on Adjustable Shelves: 5

**TORSO/SKELETON
STORAGE**

47722



W : 24
H : 84, 90
D : 23

- Right Hinge Display Door
- Pullout Skeleton Rack
- Slideout Torso Shelf
- Adjustable Shelf

**APPARATUS
ROD STORAGE**

47712



W : 15, 18
H : 84, 90
D : 23

- Right Hinge Door
- Vertical Storage Compartments: 2
- Shelf
- Clamp Bin

**TORSO/SKELETON
STORAGE**

47723



W : 24
H : 84, 90
D : 23

- Left Hinge Display Door
- Pullout Skeleton Rack
- Slideout Torso Shelf
- Adjustable Shelf

**APPARATUS
ROD STORAGE**

47713



W : 15, 18
H : 84, 90
D : 23

- Left Hinge Door
- Vertical Storage Compartments: 2
- Shelf
- Clamp Bin

**MICROSCOPE
STORAGE**



47728

W : 24
H : 84, 90
D : 19, 23

- Right Hinge Door
- Black A-tech Shelving
- Vertical Dividers
- Compartments: 15

**MICROSCOPE
STORAGE**



47730

W : 24
H : 84, 90
D : 19, 23

- Right Hinge Display Door
- Black A-tech Shelving
- Vertical Dividers
- Compartments: 15

**MICROSCOPE
STORAGE**



47729

W : 24
H : 84, 90
D : 19, 23

- Left Hinge Door
- Black A-tech Shelving
- Vertical Dividers
- Compartments: 15

**MICROSCOPE
STORAGE**



47731

W : 24
H : 84, 90
D : 19, 23

- Left Hinge Display Door
- Black A-tech Shelving
- Vertical Dividers
- Compartments: 15

**MICROSCOPE
STORAGE**



47732

W : 36
H : 84, 90
D : 19, 23

- Doors
- Black A-tech Shelving
- Vertical Dividers
- Compartments: 20

**MICROSCOPE
STORAGE**



47733

W : 36
H : 84, 90
D : 19, 23

- Display Doors
- Black A-tech Shelving
- Vertical Dividers
- Compartments: 20

Stack-On units are designed to be placed on top of standard tall cabinets, allowing additional upper storage utilization.

Advantage Scientific cabinets can be produced to a maximum 90H nominal in a one-piece vertical assembly. When taller cabinet assemblies are desired, Stack-On units provide the solution. Stack-Ons may be added to 84H nominal (2137mm / 84.13") and 90H nominal (2297mm / 90.43") Tall cabinets.

Stack-On units may also be utilized to span more than one Tall cabinet below. For example, two 24"-wide Tall units could use a single 48"-wide Stack-On. Note that, due to side hinge reveals, vertical gaps will align, but width spacing of gaps may vary due to hinge hardware selected.

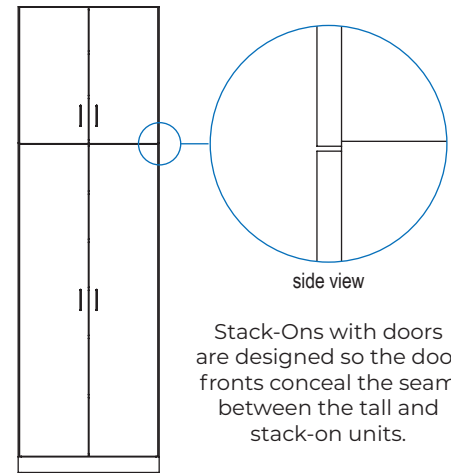

**STACK-ON
WITH
84H TALL**

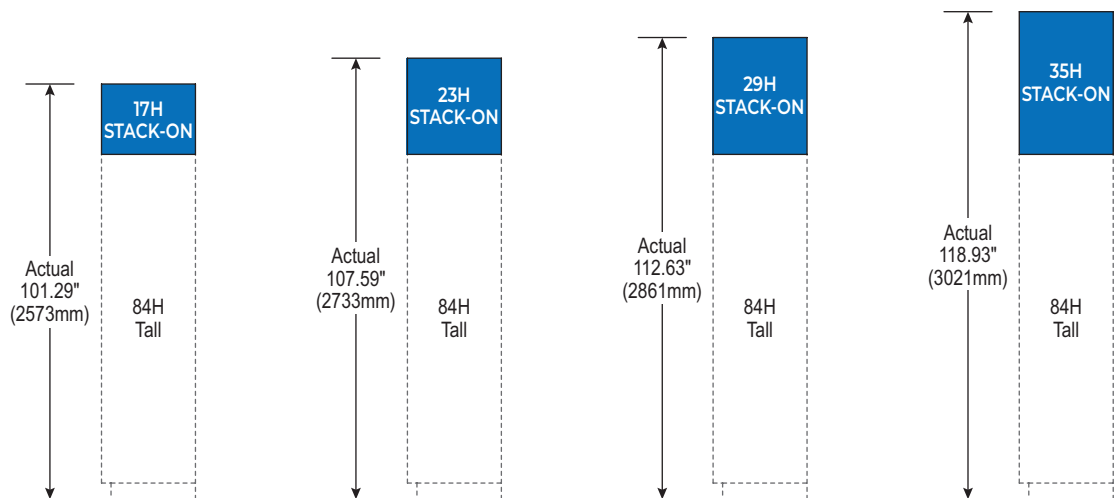

**STACK-ON
WITH
90H TALL**

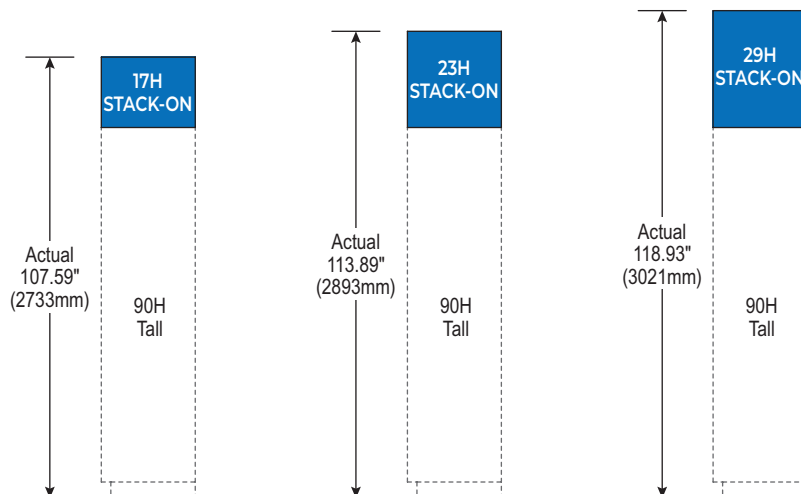

SHELF

W : 15-36
H : 17, 23, 29, 35
D : 14, 17, 19, 23

- Open Storage
- Adjustable Shelves (23H-35H only)

SHELF

W : 15-24
H : 17, 23, 29, 35
D : 14, 17, 19, 23

- Right Hinge Door
- Adjustable Shelves (23H-35H only)

SHELF

W : 15-24
H : 17, 23, 29, 35
D : 14, 17, 19, 23

- Left Hinge Door
- Adjustable Shelves (23H-35H only)

SHELF

W : 27-48
H : 17, 23, 29, 35
D : 14, 17, 19, 23

- Doors
- Adjustable Shelves (23H-35H only)

43500

43502

43504

43506

17H

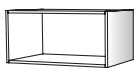

23H
29H



35H

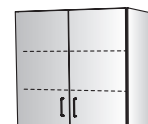

SHELF

W : 39-48
H : 17, 23, 29, 35
D : 14, 17, 19, 23

- Center Divider
- Adjustable Shelves (23H-35H only)

SHELF

W : 39-48
H : 17, 23, 29, 35
D : 14, 17, 19, 23

- Doors
- Center Divider
- Adjustable Shelves (23H-35H only)

SHELF

W : 42, 48
H : 17, 23, 29, 35
D : 17, 19, 23

- Sliding Doors
- Center Divider
- Adjustable Shelves (23H-35H only)

43508

43510

43520

17H



23H
29H

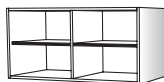

35H

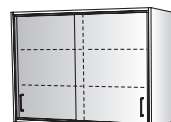
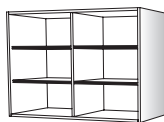

DISPLAY

W : 15-24
H : 23, 29, 35
D : 14, 17, 19, 23

- Right Hinge Display Door
- Adjustable Shelves

DISPLAY

W : 15-24
H : 23, 29, 35
D : 14, 17, 19, 23

- Left Hinge Display Door
- Adjustable Shelves

DISPLAY

W : 30, 36
H : 23, 29, 35
D : 14, 17, 19, 23

- Display Doors
- Adjustable Shelves

DISPLAY

W : 30, 36, 42, 48
H : 23, 29, 35
D : 14, 17, 19, 23

- Display Doors
- Center Divider
- Adjustable Shelves

43512

43514

43518

43516

23H
29H

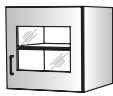

35H



DISPLAY

W : 42, 48
H : 23, 29, 35
D : 17, 19, 23

- Sliding Display Doors
- Center Divider
- Adjustable Shelves

DISPLAY

W : 42, 48
H : 17, 23, 29, 35
D : 17, 19, 23

- Sliding Glass Doors
- Center Divider
- Adjustable Shelves (23H-35H only)

43522

43524

17H



23H
29H



35H

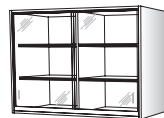

SOFFIT TRIM



25801

W : 96
H : 00
D : 03

- Field Trim to Fit
- Actual Thickness: 3/4"
- Actual Depth: 3"
- Edgebanding: One Long Edge in Casebody Trim Color and 0.5mm Thickness

SIDE FILLER

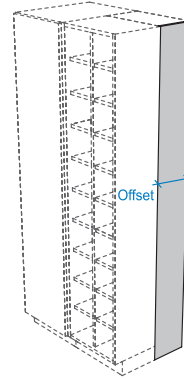

Shown with
25810 Top
Back Closure

25807

W : 00
H : 84, 90
D : 04-24

- Field Trim to Fit
- Edgebanding: One Long Edge in Casebody Trim Color and Thickness

FRONT FILLER

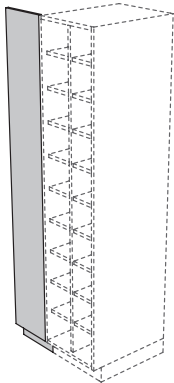

25803

W : 01-12
H : 84, 90
D : 14, 17, 19, 23

- Field Trim to Fit
- Edgebanding: None

TOP BACK CLOSURE

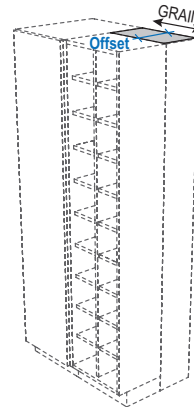

Shown with
25807 Side
Filler

25810

W : 12-96
H : 00
D : 04-24

- Horizontal Grain
- Field Trim to Fit
- Edgebanding: None

CORNER FILLER

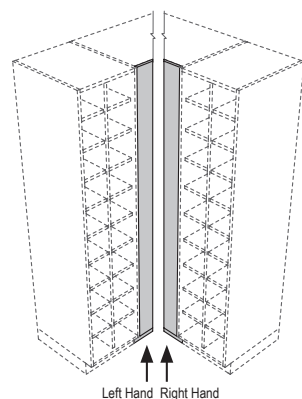

25805

W : 01-12
H : 84, 90
D : 14, 17, 19, 23

- Field Trim to Fit
- Depths Listed are Depths of Cabinets to which Filler is Attached
- Edgebanding: None

FRONT / TOP FILLER

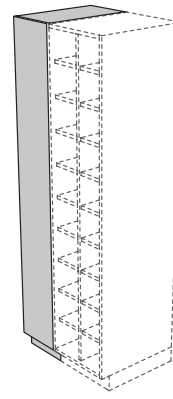

25811

W : 01-12
H : 84, 90
D : 14, 17, 19, 23

- Field Trim to Fit
- Edgebanding: None

END SOFFIT CLOSURE

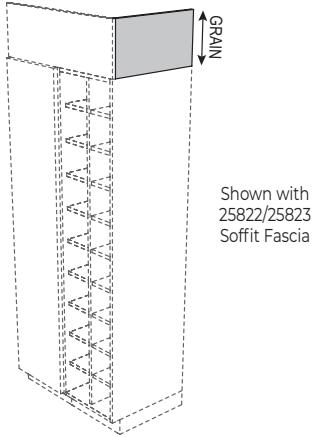

25820

W : 00
H : 12-25
D : 14, 17, 19, 23

- Vertical Grain
- Edgebanding: All Edges in Casebody Trim Color and 0.5mm Thickness

INTERMEDIATE SOFFIT BRACKET

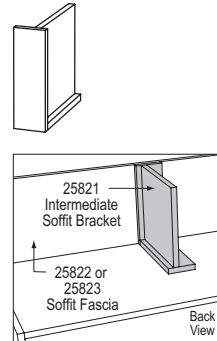

25821

W : 04
H : 12
D : 12

- Provides Added Support for Longer 25822 and 25823 Soffit Fascias
- Edgebanding: None

SOFFIT FASCIA

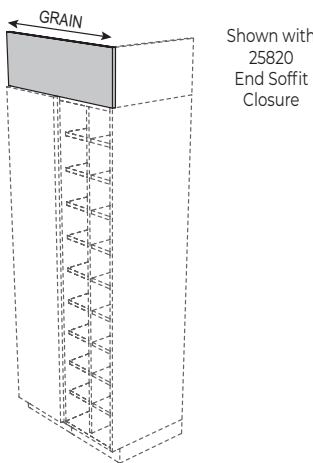

25822

W : 12-96
H : 12-25
D : 00

- Horizontal Grain
- Edgebanding: One Long and Two Short Edges in Casebody Trim Color and 0.5mm Thickness

SOFFIT EXTENSION

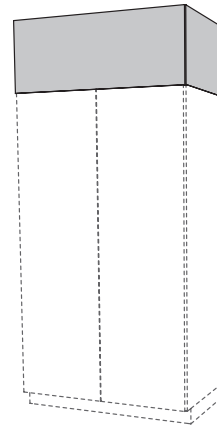

25824

W : 12-48
H : 6"-34" (1" increments)
D : 14, 17, 19, 23

- Edgebanding (Box): All Edges in Casebody Trim Color and Thickness
- Edgebanding (Soffit Panel): All Edges in Door/Drawer Trim Color and Thickness

SOFFIT FASCIA

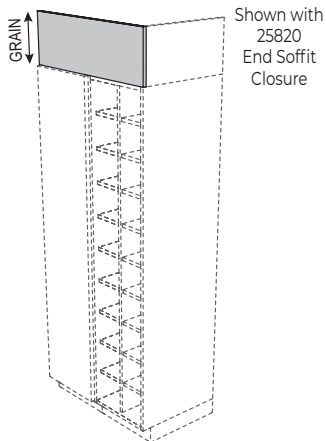

25823

W : 12-48
H : 12-25
D : 00

- Vertical Grain
- Edgebanding: One Short and Two Long Edges in Casebody Trim Color and 0.5mm Thickness

OVERLAY TOP

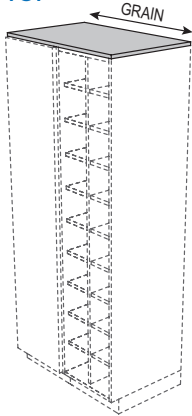

25830

W : 36, 48, 60, 72, 84, 96
H : 00
D : 14, 17, 19, 23

- Horizontal Grain
- Shipped in Lengths for Field Trimming
- Edgebanding: One Long and Two Short Edges in Casebody Trim Color and Thickness

FILE CROSSBARS

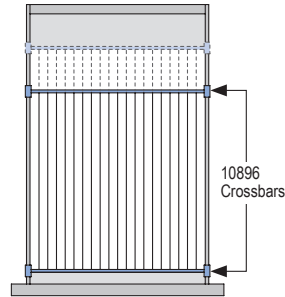

(TOP VIEW)
Letter File Drawer
with optional crossbars
installed for side filing

10896

W : 16
H : 01
D : 00

- Pair of Crossbars for 16W File Drawers (letter)
- Allow Side Filing

OVERLAY BACK FULL HEIGHT

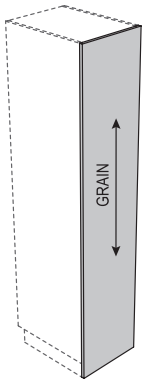

25813

W : 12-48
H : 84, 90
D : 00

- Vertical Grain
- Full Height
- Order by Cabinet Height
- Edgebanding: All Edges in Casebody Trim Color and Thickness

FILE CROSSBARS

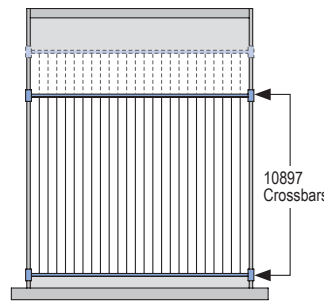

(TOP VIEW)
Legal File Drawer
with optional crossbars
installed for side filing

10897

W : 19
H : 01
D : 00

- Pair of Crossbars for 19W File Drawers (legal)
- Allow Side Filing

OVERLAY BACK ABOVE KICK

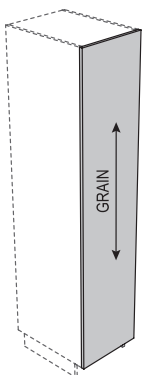

25814

W : 12-48
H : 84, 90
D : 00

- Vertical Grain
- Above Kick
- Bottom Edge Aligns with Toe Kick
- Order by Cabinet Height
- Edgebanding: All Edges in Casebody Trim Color and Thickness

FILE BARS

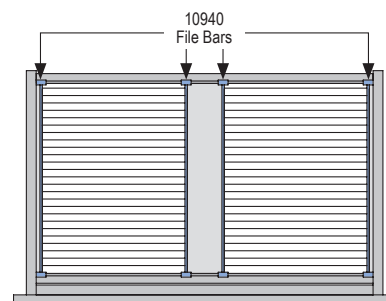

(TOP VIEW)
Lateral File Drawer
with two pairs of optional file bars
installed for front-to-back filing

10940

W : 00
H : 01
D : 18

- 1 Pair of File Bars for Lateral File Drawers
- Allow Front-to-Back Filing
- 1 Pair Required for 24W-27W Lateral File Drawers
- 2 Pairs Required for 30W-42W Lateral File Drawers