

TERMS AND CODES	2	GLOSSARY TERMS	2
		PRODUCT CODES	2

COUNTERTOPS

PHENOLIC	3	CP00 CHEMICAL RESISTANT PHENOLIC - BEVELED EDGE	3
EPOXY RESIN	4	ES00 EPOXY - BEVELED EDGE	4
		ES02 EPOXY - MARINE EDGE	5
LAMINATE	6	LS05 LAMINATE - 3MM EDGE	6
		LS07 LAMINATE - SELF EDGE	6
		LS25 CHEMICAL RESISTANT LAMINATE - 3MM EDGE	7
		LS26 CHEMICAL RESISTANT LAMINATE - SELF EDGE	7
STAINLESS STEEL	9	SS00 STAINLESS STEEL - FORMED EDGE	9
		SS01 STAINLESS STEEL - MARINE EDGE	9
HARDWOOD	10	WD00 HARDWOOD MAPLE LUMBER - SANDED EDGE	10

WINDOWSILLS

PHENOLIC	3	CP10 CHEMICAL RESISTANT PHENOLIC - BEVELED EDGE	3
EPOXY RESIN	4	ES10 EPOXY - BEVELED EDGE	4
LAMINATE	8	LS50 LAMINATE - SELF EDGE	8

REV. 08-19-24

©2023 STEVENS INDUSTRIES, INC.
ALL RIGHTS RESERVED.
Due to continuing product
development, Stevens reserves
the right to change specifications
without notice.

Stevens Industries, Inc., from its initial founding in 1956, has provided a complete solution of cabinets and countertops fabricated and coordinated as a full product offering. Stevens Advantage countertops, included with the wide range of cabinets and millwork, can complete the entire project's requirements. Countertops are available in several versions of laminate, epoxy resin, hardwood, phenolic, stainless steel and hardwood. The following technical descriptions and design data illustrate the available designs. Beyond those shown, Stevens Millwork can also provide unique special applications.

GLOSSARY OF TERMS:

3mm Edge:	Edge with high impact 3mm (1/8") thickness extrusion (patterns available from Stevens standard offering)
Backer:	Underside faced with laminate backer
HGS:	Horizontal Grade Standard
HPL:	High Pressure Laminate
Marine Edge:	Raised outside countertop edge
Self Edge:	Edges laminated with same High Pressure Laminate as countertop face
TFL:	Thermally Fused Laminate

COUNTERTOP PREFIX CODES:

CP:	Phenolic	SS:	Stainless Steel
ES:	Epoxy Resin	WD:	Laminated Hardwood (Butcher Block)
LS:	Laminate		

CORES:

Laminate countertops are offered in the following cores:

(Some cores not available in all thicknesses, see series offering for full details)

Particleboard

- Ultra Low Emitting Formaldehyde Particleboard
- Moisture Resistant Particleboard
- Ultra Low Emitting Formaldehyde Moisture Resistant Particleboard
- Fire Rated Particleboard

Medium Density Fiberboard

- Ultra Low Emitting Formaldehyde Medium Density Fiberboard
- Moisture Resistant Medium Density Fiberboard
- Ultra Low Emitting Formaldehyde Moisture Resistant Medium Density Fiberboard
- Fire Rated Medium Density Fiberboard

Plywood

CP00

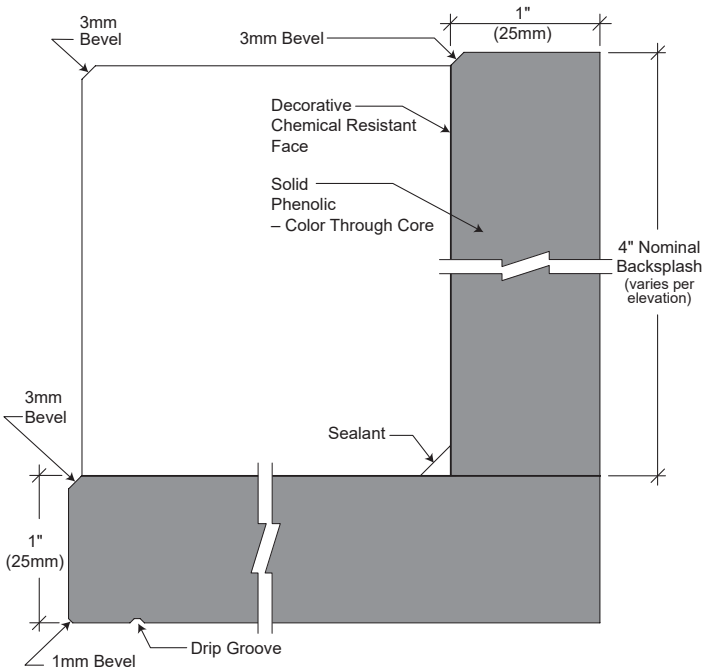

CP00 PHENOLIC

- Solid phenolic core (color through core) with chemical resistant face
- 3mm beveled top edge, polished for consistent edge look
- Applied backsplash and endsplash
- Drip groove

AVAILABLE COUNTERTOP THICKNESSES:

- Phenolic**
19mm (3/4")
25mm (1")

PHENOLIC WINDOWSILLS

CP10

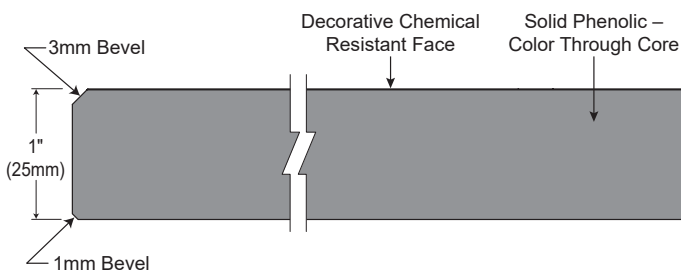

CP10 PHENOLIC WINDOWSILL

- Solid phenolic core (color through core) with chemical resistant face
- 3mm beveled top edge, polished for consistent edge look

AVAILABLE WINDOWSILL THICKNESSES:

- Phenolic**
19mm (3/4")
25mm (1")

ES00 EPOXY RESIN

- Solid epoxy resin
- 3mm beveled edges with smooth edge finish
- Applied backsplash and endsplash
- Drip groove
- Butt joints and attachment with field applied epoxy sealant and adhesives
- Epoxy resin coordinated sinks where specified
- Factory fabricated cutouts and drillings

AVAILABLE COUNTERTOP THICKNESSES:

Epoxy

- 19mm (3/4")
- 25mm (1")

ES00

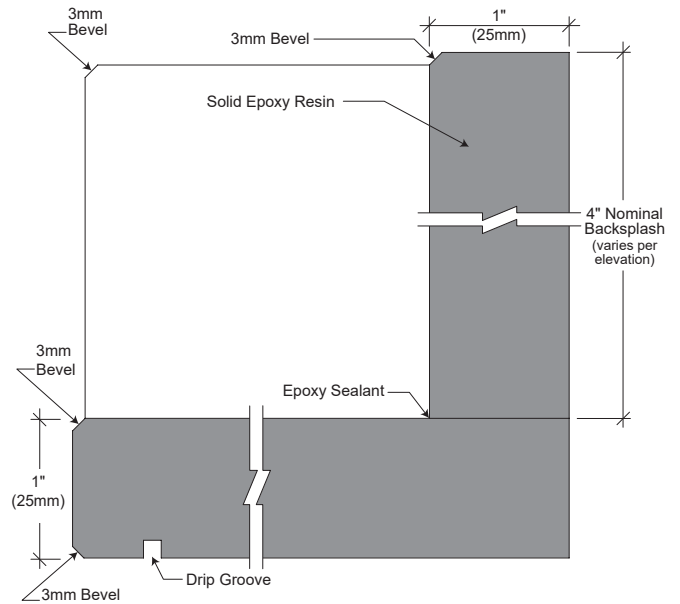

EPOXY RESIN WINDOWSILLS

ES10 EPOXY RESIN

- Solid epoxy resin
- Beveled edge with smooth edge finish

AVAILABLE WINDOWSILL THICKNESSES:

Epoxy

- 19mm (3/4")
- 25mm (1")

ES10

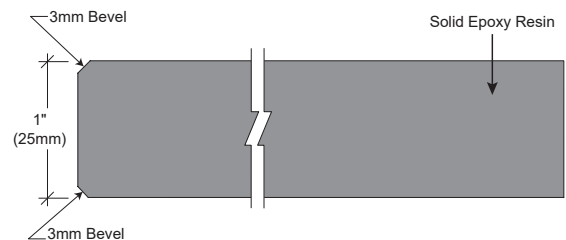

ES02

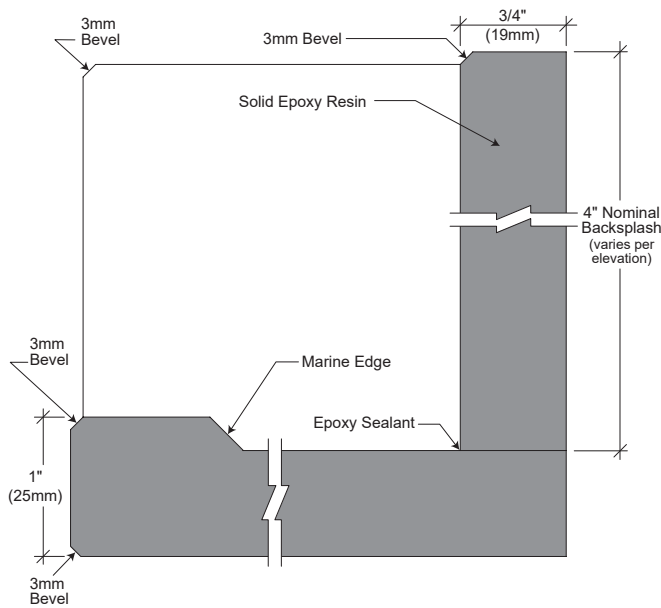

ES02 EPOXY RESIN

- Solid epoxy resin
- Lipped marine edge
- 3mm beveled edges with smooth edge finish
- Applied backsplash and endsplash
- Butt joints and attachment with field applied epoxy sealant and adhesives
- Epoxy resin coordinated sinks where specified
- Factory fabricated cutouts and drillings

AVAILABLE COUNTERTOP THICKNESS:

Epoxy
25mm (1")

LS05 LAMINATE

- 3mm edge top
- Applied 3mm edge backsplash and endsplash
- Backsplash/Endsplash thickness = Top Thickness, except when Top is 40mm thick, then it has 3/4" splashes.

AVAILABLE COUNTERTOP THICKNESSES:

All Cores Except Plywood

- 21mm (13/16")
- 27mm (1-1/16")
- 30mm (1-3/16") (n/a for fire-rated particleboard)
- 40mm (1-9/16")* (n/a for fire-rated MDF)

Plywood

- 27mm (1-1/16")
- 40mm (1-9/16")*

*Edges: specific patterns only

LS05

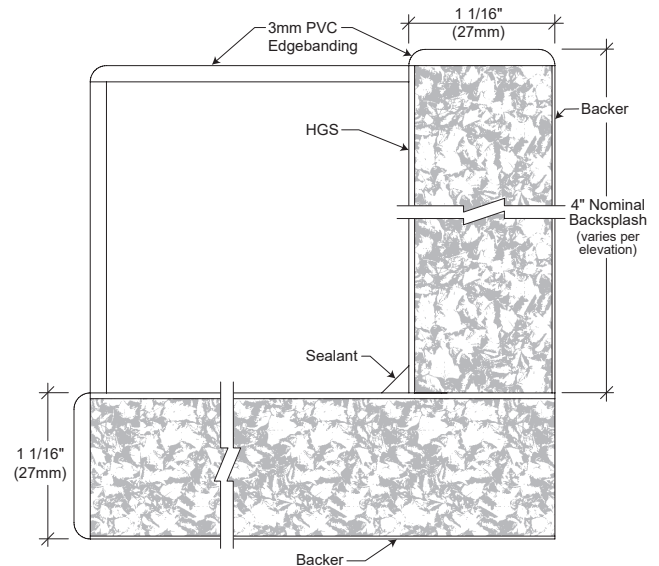

LS07 LAMINATE

- Self edge top
- Applied self edge backsplash and endsplash
- Backsplash/Endsplash thickness = Top Thickness, except when Top is 40mm thick, then it has 3/4" splashes.

AVAILABLE COUNTERTOP THICKNESSES:

All Cores Except Plywood

- 21mm (13/16")
- 27mm (1-1/16")
- 30mm (1-3/16") (n/a for fire-rated particleboard)
- 40mm (1-9/16") (n/a for fire-rated MDF)

Plywood

- 27mm (1-1/16")
- 40mm (1-9/16")

Drop edge available upon special request in 1/2" increments, from 2" to 6". Drop edge not available over casework.

LS07

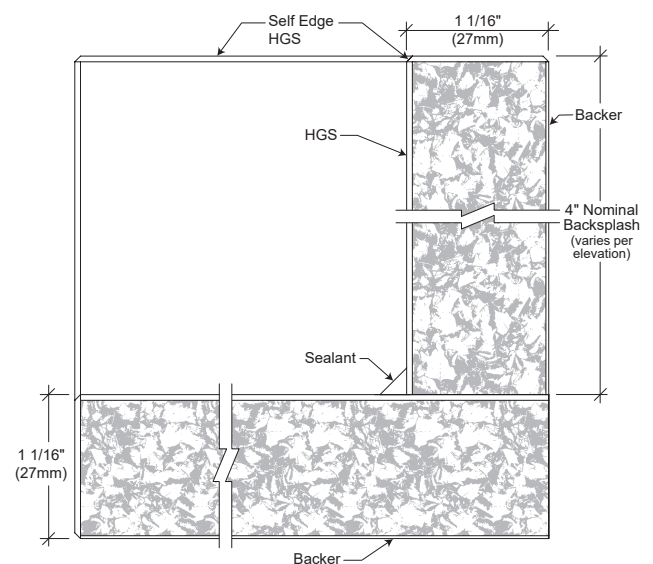

LS25

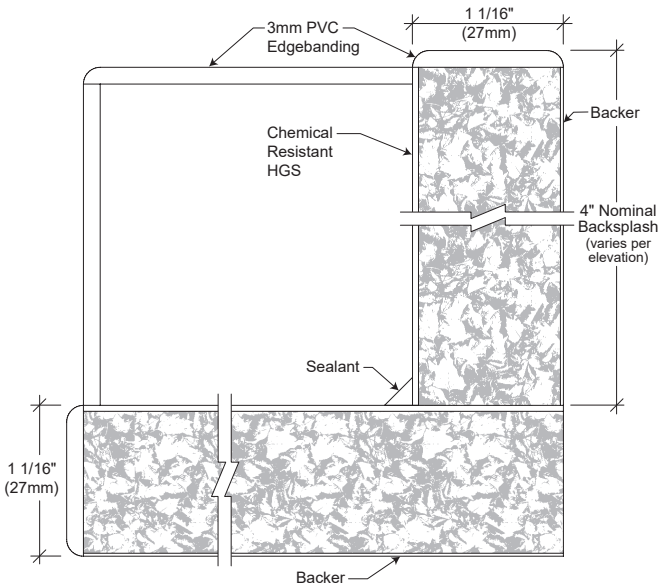

LS25 CHEMICAL RESISTANT LAMINATE

- Chemical resistant face laminate
- 3mm edge top
- Applied 3mm edge backsplash and endsplash
- Backsplash/Endsplash thickness = Top Thickness, except when Top is 40mm thick, then it has 3/4" splashes.

AVAILABLE COUNTERTOP THICKNESSES:

All Cores Except Plywood

- 21mm (13/16")
- 27mm (1-1/16")
- 30mm (1-3/16") (n/a for fire-rated particleboard)
- 40mm (1-9/16")* (n/a for fire-rated MDF)

Plywood

- 27mm (1-1/16")
- 40mm (1-9/16")*

*Edges: specific patterns only

LS26

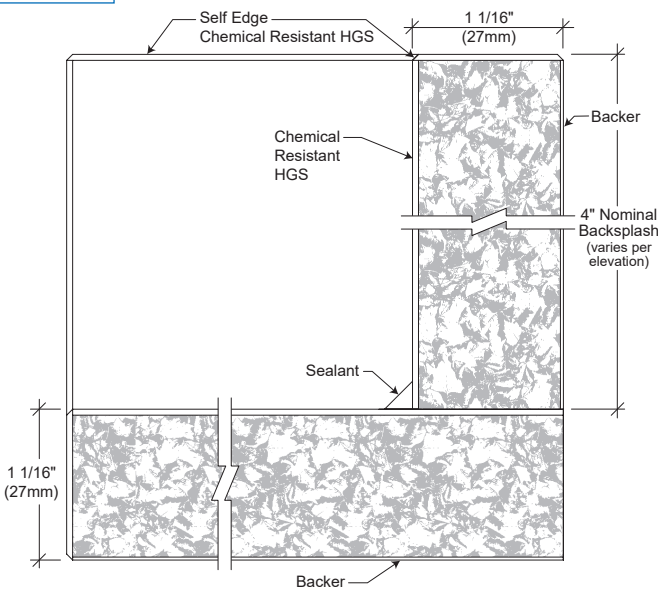

LS26 CHEMICAL RESISTANT LAMINATE

- Chemical resistant face laminate
- Self edge top
- Applied self edge backsplash and endsplash
- Backsplash/Endsplash thickness = Top Thickness, except when Top is 40mm thick, then it has 3/4" splashes.

AVAILABLE COUNTERTOP THICKNESSES:

All Cores Except Plywood

- 21mm (13/16")
- 27mm (1-1/16")
- 30mm (1-3/16") (n/a for fire-rated particleboard)
- 40mm (1-9/16") (n/a for fire-rated MDF)

Plywood

- 27mm (1-1/16")
- 40mm (1-9/16")

Drop edge available upon special request in 1/2" increments, from 2" to 6". Drop edge not available over casework.

LS50 LAMINATE

- Self Edge

LS50

AVAILABLE WINDOWSILL THICKNESSES:

All Cores Except Plywood

- 21mm (13/16")
- 27mm (1-1/16")
- 30mm (1-3/16") (n/a for fire-rated particleboard)
- 40mm (1-9/16")* (n/a for fire-rated MDF)

Plywood

- 27mm (1-1/16")
- 40mm (1-9/16")*

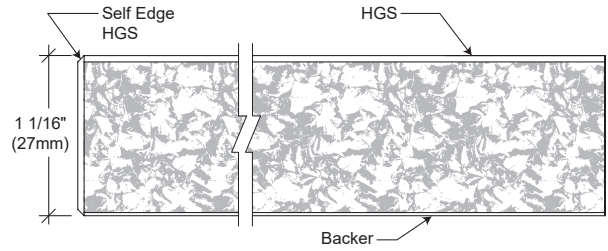

SS00 STAINLESS STEEL

- Formed edge design with integral cove
- Fabricated from 16-gauge 304 stainless steel
- Formed edges and bends with welded and polished corners
- Can be fabricated with or without backsplash or endsplash

AVAILABLE COUNTERTOP THICKNESSES:

Stainless Steel
29mm (1-1/8")

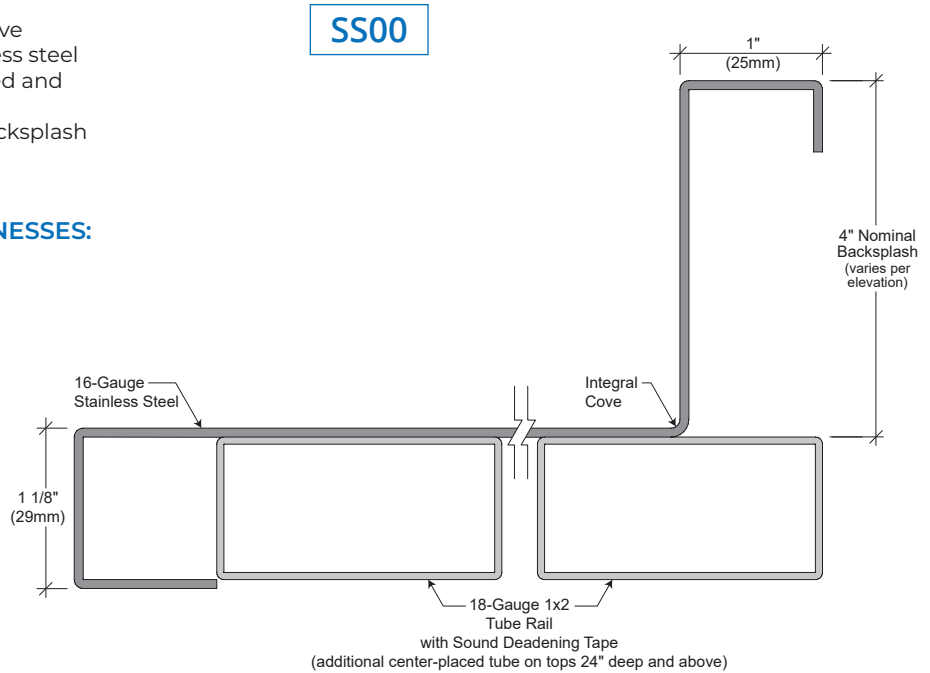

SS01 STAINLESS STEEL

- Marine edge design with integral cove
- Fabricated from 16-gauge 304 stainless steel
- Formed edges and bends with welded and polished corners
- Can be fabricated with or without backsplash or endsplash

AVAILABLE COUNTERTOP THICKNESSES:

Stainless Steel
38mm (1-1/2")

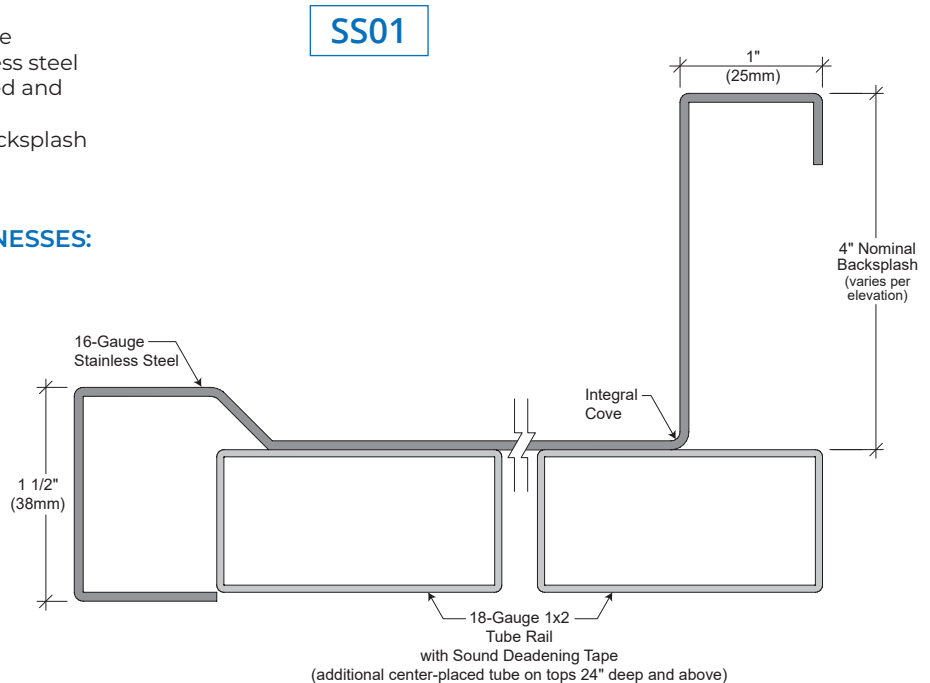

WD00

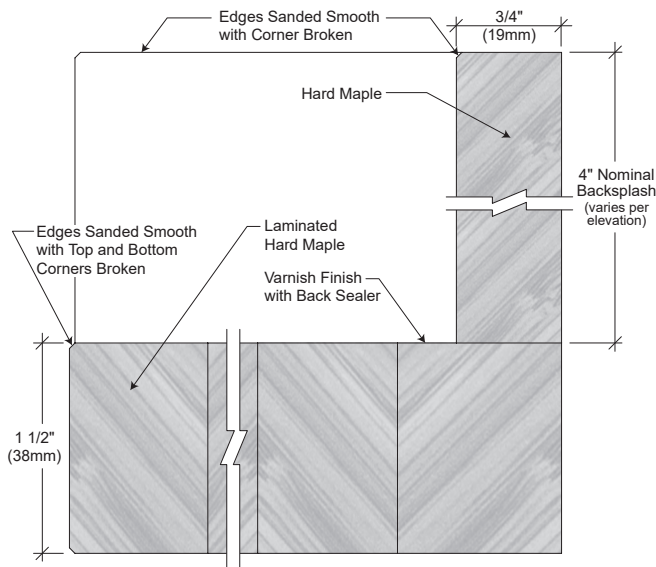

WD00 HARDWOOD

- Fabricated from laminated kiln dried hard maple lumber
- Industrial grade with butt joints and edge grain fabrication (butcher block) design
- Edges sanded smooth with top and bottom corners broken
- Faces and edges sealed with varnish finish

AVAILABLE COUNTERTOP THICKNESSES:

Hardwood
38mm (1-1/2")
44mm (1-3/4")

Note: Maple lumber tops are susceptible to changes due to moisture, heat and cold conditions. Warpage and edge splitting may occur under unusual field conditions. Wood tops should only be delivered and installed after project HVAC systems are working and balanced for normal interior conditions. Never store or use in high or low humidity with cyclical conditions.